

Overview

T6-200 mounting config for Bell 407 Helicopters

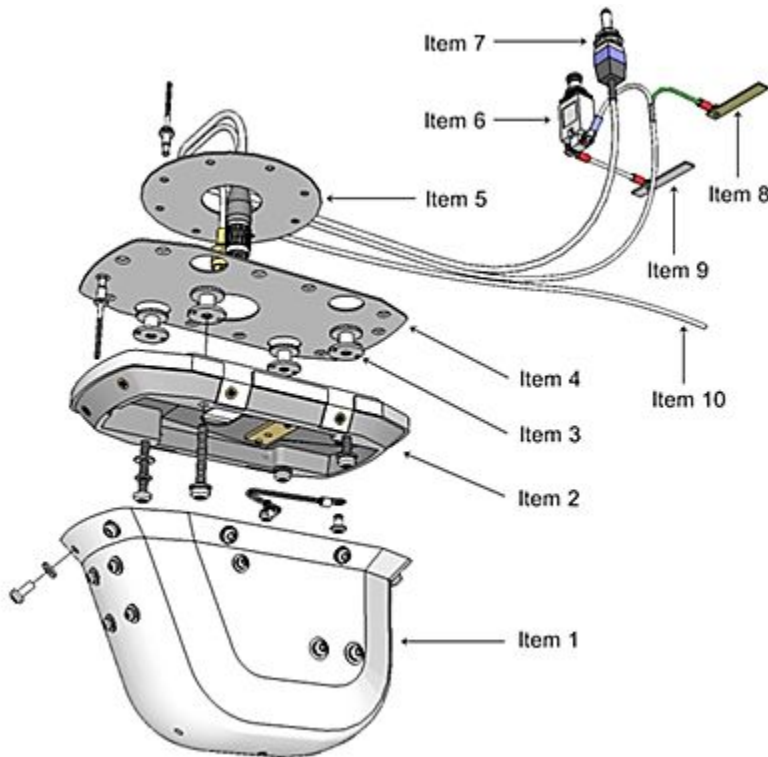

- Item 1 – Camera Assembly
- Item 2 – Transition Plate
- Item 3 – Potting Inserts
- Item 4 – Outer Doubler
- Item 5 – Inner Doubler
- Item 6 – Circuit Breaker
- Item 7 – Trim Control Switch
- Item 8 – AF Ground
- Item 9 – 28V Buss
- Item 10 – Video Lead to Display (407G or GX)

Bell 407 installations are straight forward where the airframe hull is modified with inner and outer doublers, installation of four potting inserts and a 1" diameter hole for harness routing. The transition plate is then secured to the hull via the four potting inserts where the camera assembly is readily installed and removed at any time.

The wiring harness is prefabricated and ready for installation. Termination to the breaker and gnd are completed during install. The video lead is terminated to the G500H or G1000 (full glass) during install IAW manufactures instructions.

The complete installation manual is available upon request.
The system is supplied as a complete kit with all parts and materials required for full installation.

STC'd with all documentation for field installation. www.trueviewevs.com



The T6-200 thermal image appears in the upper LH portion of the G500H displays and full screen on G1000 full glass displays.

The console mounted camera trim control enables aiming from 0 to -28° fwd looking.